

**NOTE:**  
 1. GAS MAIN CONTRACTOR SHALL COORDINATE WITH WATER AND SEWER CONTRACTOR PRIOR TO COMMENCING RELOCATION WORK.  
 2. RENEW OR TIE-OVER SERVICES TO NEW GAS MAIN AS NEEDED.

PROPOSED 2,000' x 2" MHP STEEL GAS MAIN TO BE INSTALLED APPROXIMATELY 3' WITHIN ROW  
 NOP = 45 PSIG  
 WT = 0.154"  
 GRADE = A25  
 CP = CANAL RD RECTIFIER

CUT & CAP TIE-IN TO EXISTING 2" MHP STEEL

RETIRE 2,000' x 2" MHP STEEL GAS MAIN  
 NOP = 45 PSIG  
 WT = UNKNOWN  
 GRADE = UNKNOWN  
 CP = CANAL RD RECTIFIER

CUT & CAP TIE-IN TO EXISTING 2" MHP STEEL

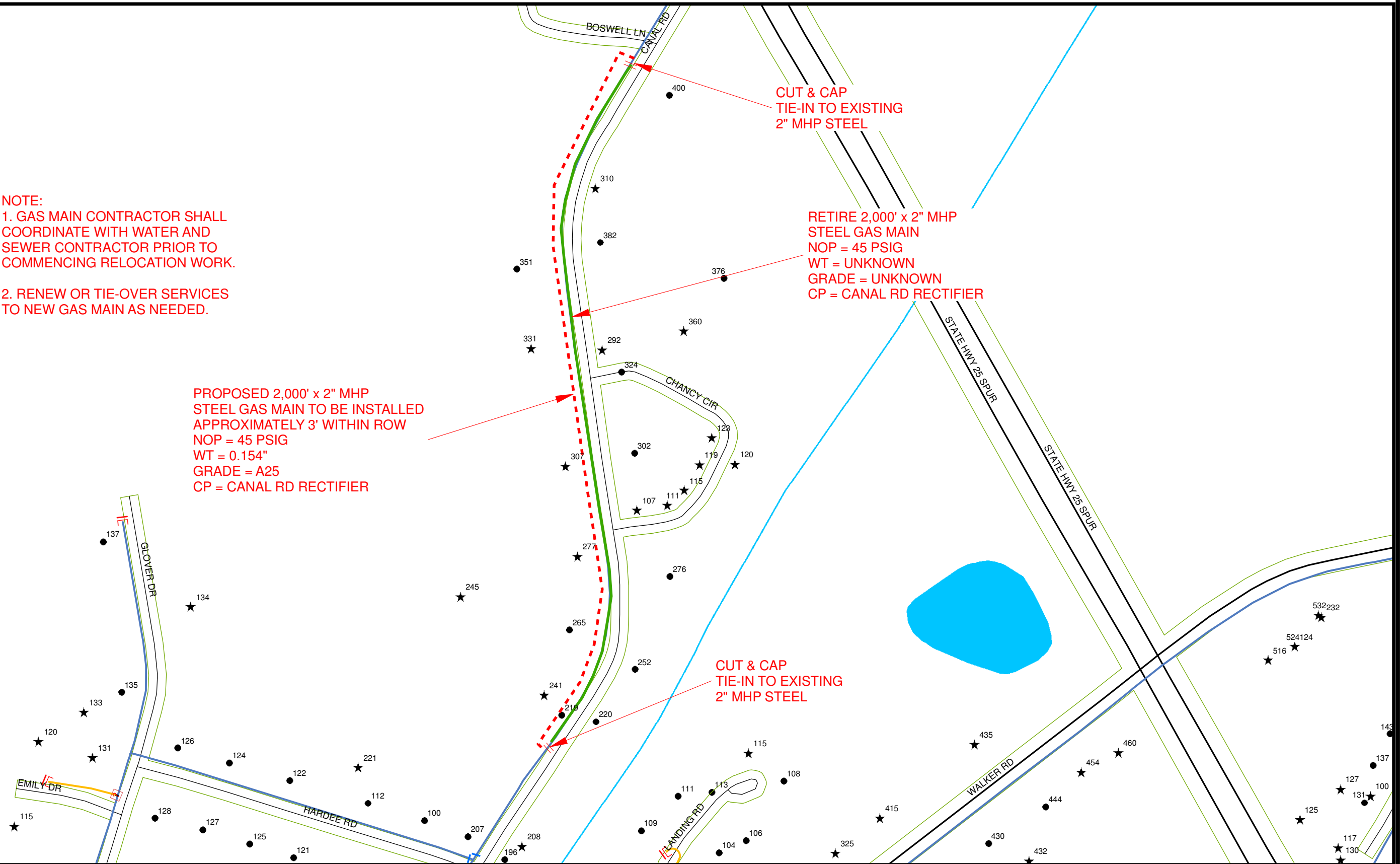

**2" STEEL RELOCATION  
 CANAL ROAD  
 4910 - BRUNSWICK SC**

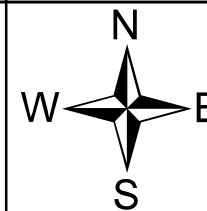

Revision Number	Revision Date

Sheet Number: 1 of 1

Drawn By:	
Checked By:	
Date:	

